

Important: Please save this instruction sheet. It contains valuable product information.

NOTE: This product works best in dim to dark light conditions.

It looks like a flashlight, but when you wave the Nightwriter, your secret message appears in the air!

USING THE FLASHLIGHT

Adults: Make sure fresh batteries are installed (see below). To turn on the light, press the **ON/OFF BUTTON**. To turn it off, press the On/off button again.

USING THE MESSENGER

1. Press **CHANGE BUTTON** to activate the messenger. The **DISPLAY WINDOW** will illuminate.
 - Press Change button again to enter **CUSTOM MESSAGE MODE**.
 - Press and hold **ENTER BUTTON** for 3 seconds to enter **PRESET MESSAGE MODE**.

CUSTOM MESSAGE MODE: Write your own message

1. Use the **SCROLL BUTTONS** to scroll the alphabet in the Display button.
2. Press Enter button to select a letter.
3. Repeat steps 1 & 2 until your message is complete. (Maximum 15 characters).
4. To erase a letter, press Change button. To erase the entire message and start over, hold Change button for 3 seconds.
5. Press Display button to enter **DISPLAY MODE**.

PRESET MESSAGE MODE: Choose a default message

1. Press the Scroll buttons to view the preset messages.
 - WATCH OUT
 - TOP SECRET
 - COAST IS CLEAR
 - OVER HERE
 - ABORT MISSION
2. Press Enter to select your message.
3. Press Display again for **DISPLAY MODE**.

DISPLAY MODE: Float your message in the air!

1. Once Display Mode is selected, your message will begin scrolling. The message can be read in the Display window.
2. To display the message to your friends, shake the Nightwriter left and right (Fig. 1). Your message will be spelled out in the air!
3. For best results, shake your wrist rather than wave your arm.

NOTE: When waving, you will hear a ball-bearing rattling—it is not a broken piece.
4. After 5 minutes of inactivity, Nightwriter will automatically power off.
5. When performance fades it is time to change the batteries (see below).

BATTERY INFORMATION:

Spy Nightwriter requires 3 AAA (LR03) batteries, not included.

ATTENTION ADULTS: TO REPLACE BATTERIES

1. Using a small Phillips screwdriver, remove the battery cover (Fig. 2). The screw will not fall out.
2. Remove the old batteries.
3. Insert the new batteries according to the diagram.
4. Replace battery cover and tighten screw.

BATTERY SAFETY

1. Only adults should install and replace batteries.
2. Do not recharge non-rechargeable batteries.
3. Remove dead or exhausted batteries.
4. Insert batteries correctly. Match positive and negative signs.
5. Do not place anything across the battery terminals.
6. Only use the batteries specified above.
7. Do not use rechargeable batteries.
8. Do not mix alkaline, standard (carbon-zinc), or rechargeable (nickel-cadmium) batteries.
9. Do not mix old and new batteries.
10. Do not dispose batteries in a fire; they may explode.
11. Dispose of batteries safely.

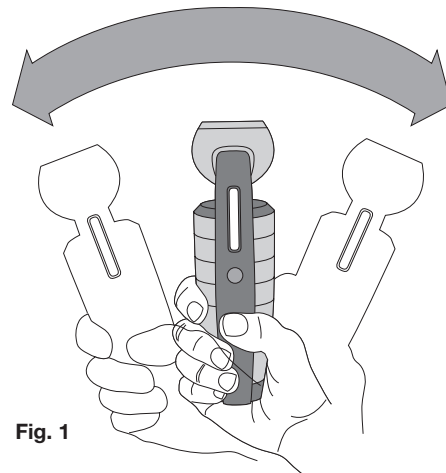
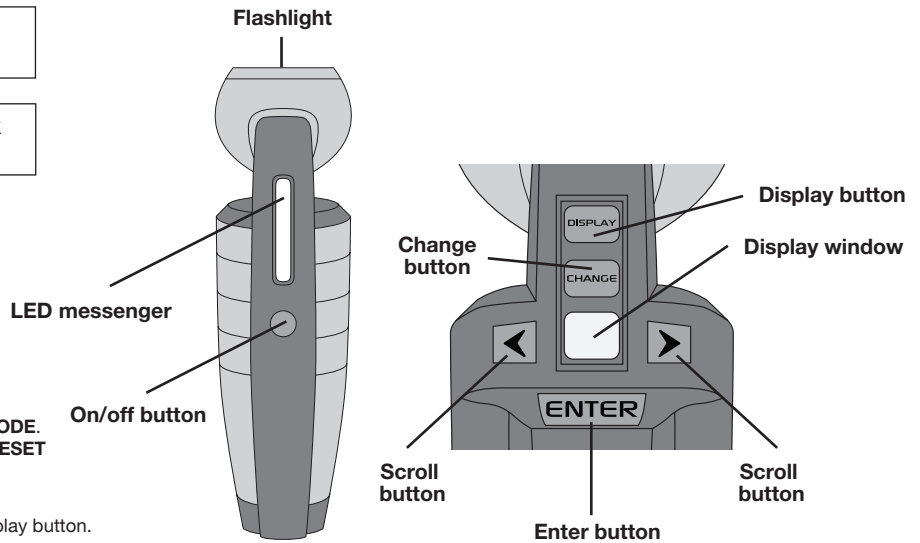

Fig. 1

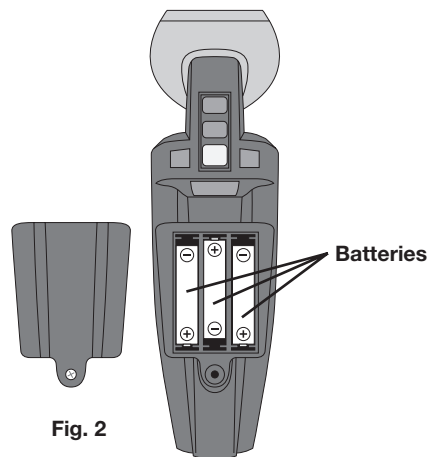

Fig. 2



SPY NIGHTWRITER 70109-4000 PR3/05

IF YOU HAVE ANY QUESTIONS, PLEASE CONTACT US AT
1-800-247-6570
WWW.WILDPLANET.COM
©2005 Wild Planet Toys, Inc.
P.O. Box 194087 San Francisco, CA 94119-4087